

Rev	Revisions	Rev.Drawn	Date
A		Du	22/12/08*

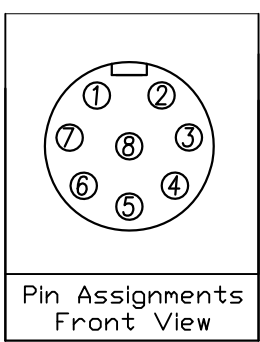
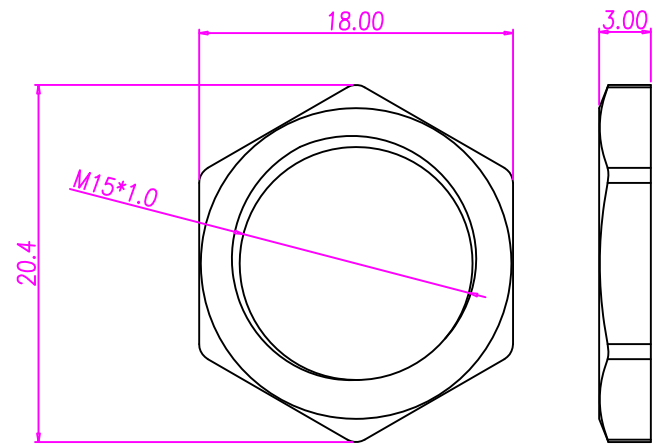
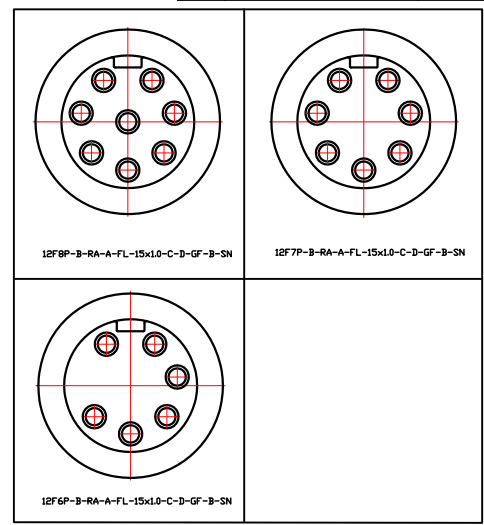
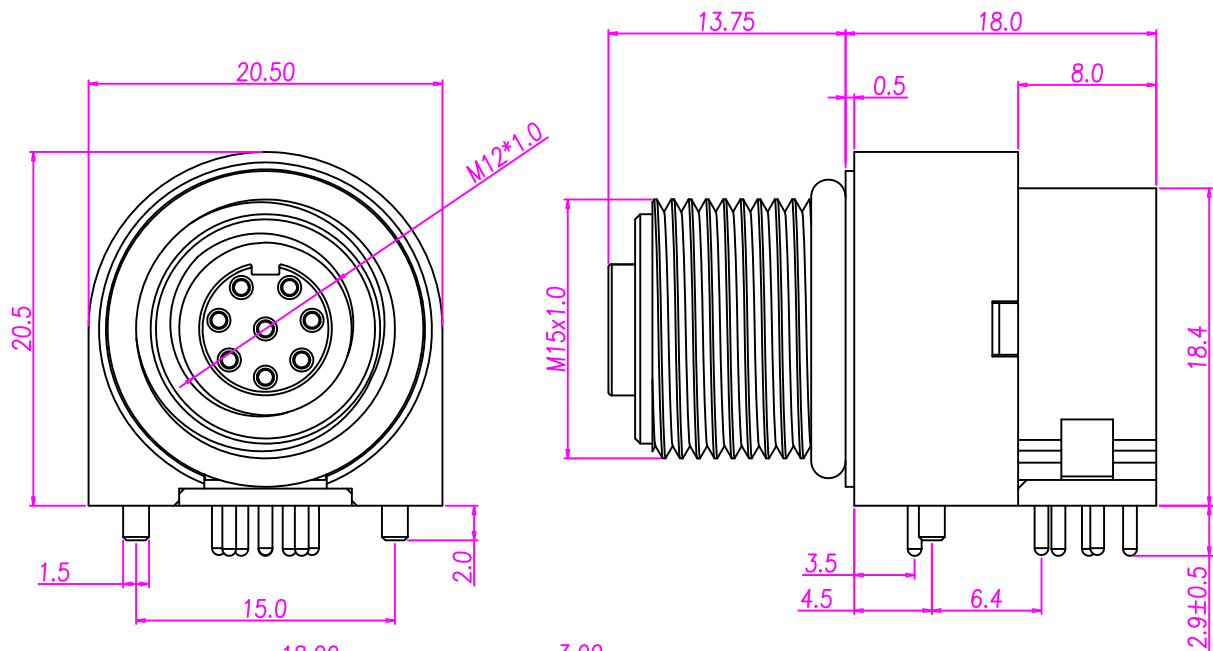

- MATERIAL :
 - 1-1. HOUSING : PBT UL94V-0 ; COLOR : BLACK
 - 1-2. CONTACT : BRASS
 - 1-3. NUT : BRASS
 - 1-4. SHELL : BRASS
 - 1-5. O-RING : EPDM ; COLOR : BLACK
 - 1-6. BACK HOUSING : PBT UL94V-0 ; COLOR : BLACK
 - 1-7. DOWN HOUSING : PBT UL94V-0 ; COLOR : BLACK
- FINISH :
 - 2-1. CONTACT : GOLD FLASH MICRO INCHES MIN. UNDER PLATE ; NICKEL
 - 2-2. NUT : NICKEL 80u"~100u" ON OVER ALL
 - 2-3. SHELL : STAIN NICKEL 80u"~100u" ON OVER ALL
- ELECTRICAL SPECIFICATION :
 - 3-1. Rated current : 3A
 - 3-2. Rated Voltage : 125V
 - 3-3. Water proof: IPX7
- Environmental :
 - 4-1. Operation Temperature : -40°~85°

NUT

SGS Report No.:		Customer:		Part No.:	
				12FBP-B-RA-A-FL-15x1.0-C-D-GF-B-SN	
Drawn By: Storm.Li		Title: M12 FEMALE 90° DIP TYPE FRONT LOCK for BOARD			
Checked By: du		SCALE	SHEET	REV.	DWG NO.:
Approved By: Tony		1:1	1/1	A	/
		Thire angle Projection		Units	
		General Dimesion Tolerance		mm	
				TOLERANCE	
				.x ±0.20	
				.xx ±0.10	
				.xxx ±0.05	
				.xxxx ±0.03	
				ANGULA ±1°	

11	12	13	14
Rev	Revisions	Rev.Drawn	Date
A		Du	22/12/08*

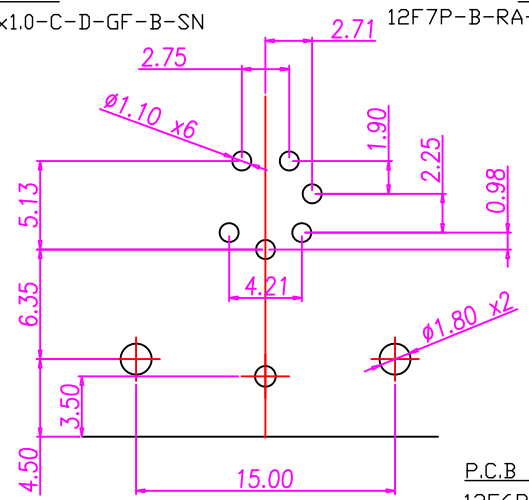
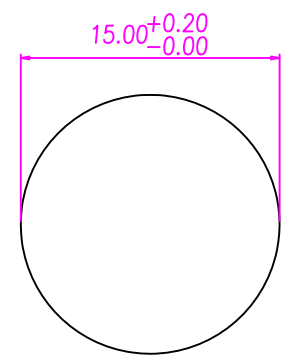
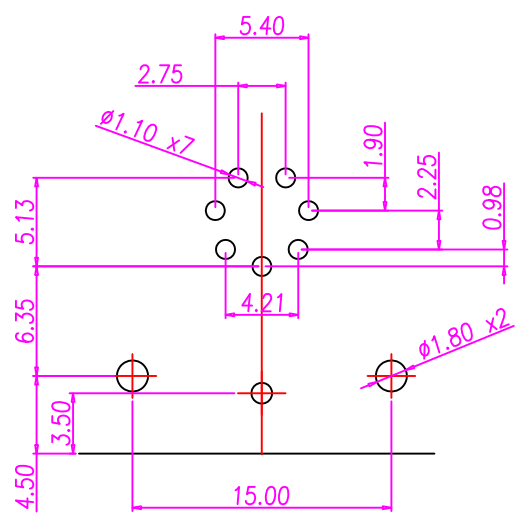
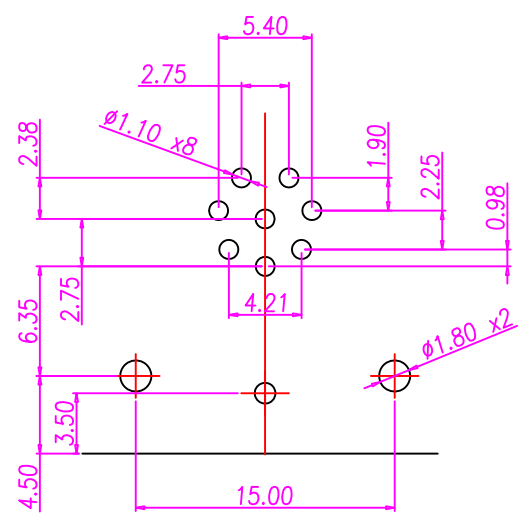

SST SOUTH SEA TERMINAL CO.,LTD

SGS Report No.:	Customer:	Part No.:
		12F8P-B-RA-A-FL-15x1.0-C-D-GF-B-SN
Drawn By: Storm.Li	Title: M12 FEMALE 90° DIP TYPE FRONT LOCK for BOARD	
Checked By: du	SCALE: 1:1	SHEET: 1/1
Approved By: Tony	REV: A	DWG NO.:
	Third angle Projection	
	General Dimension Tolerance	
	Units: mm	TOLERANCE
		.x ±0.20
		.xx ±0.10
		.xxx ±0.05
		.xxxx ±0.03
		ANGULA ±1°

Rev	Revisions	Rev.Drawn	Date
A		Du	22/12/08*

- 步驟一:
1. 將成品一一放入包裝盤內, 依同一方向置入.
 2. 包裝方式, 如圖所示.
 3. 一個包裝盤25pcs.
 4. 裝滿盤後堆層至10盤止, 最上層為空盤做蓋子(共11盤)
 5. 層疊11盤後, 在以膠膜固定

- 步驟二:
1. 一個紙箱可以裝20個包裝盤.
 2. 每盤25pcs, 每箱500pcs.
 3. 將包裝盤放紙箱中, 後封箱.

- 步驟三:
1. 用膠帶將紙箱封實.
 2. 將標籤貼於紙箱上.

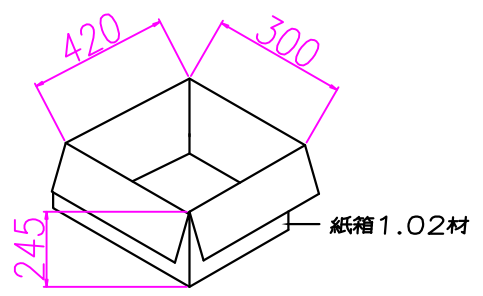
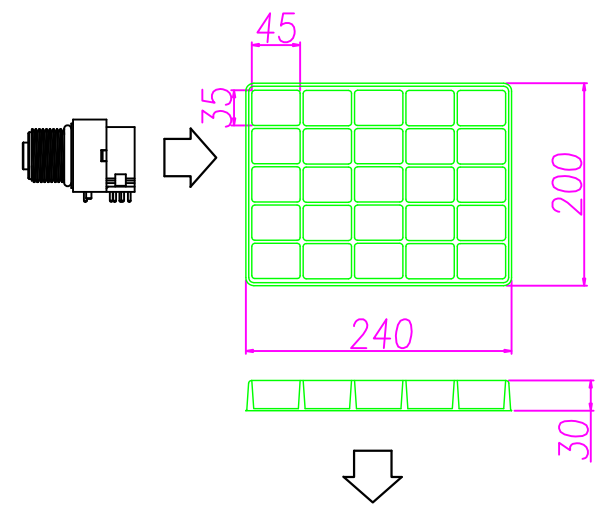

ITEM NO:
 QTY: PGS
 N. W. : KG
 G. W. : KG
 MEAS:

標籤處

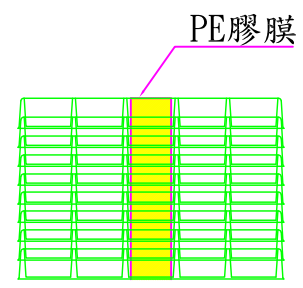
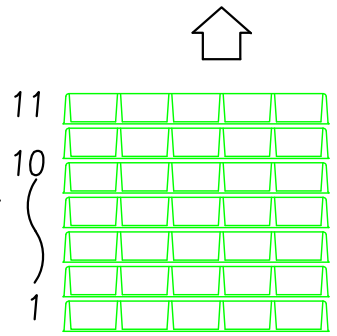
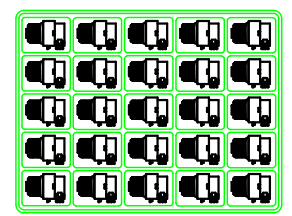
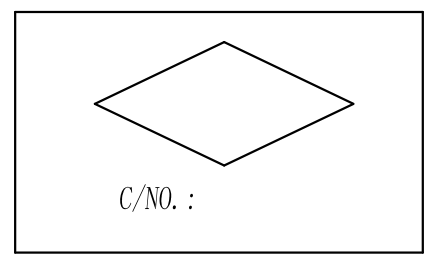

1. 若有未裝滿之零數箱, 必須以緩衝材塞滿.
2. 在搬運過程中要輕拿輕放.
3. 載運輸中不可堆放過多, 不可有重壓現象.
4. PE膠膜纏繞時不可緊綁.
5. 紙箱內層需裝防水袋.

SST SOUTH SEA TERMINAL CO.,LTD

SGS Report No.:	Customer:	Part No.:
		12FBP-B-RA-A-FL-15x1.0-C-D-GF-B-SN
Title: M12 FEMALE 90° DIP TYPE FRONT LOCK for BOARD		
Drawn By: Storm.Li	SCALE	SHEET
Checked By: du	1:1	1/1
Approved By: Tony	REV. A	
Thire angle Projection		DWG NO.:
General Dimension Tolerance		Units
		mm
		TOLERANCE
		.x ±0.20
		.xx ±0.10
		.xxx ±0.05
		.xxxx ±0.03
		ANGULA ±1°