

Material: Brass
 Thickness: 0.2mm
 Plating: Tin plated
 Wire Range: Suitable for
 AWG#22-24
 Insulation D.D: 2.5mm(max)
 Q'TY: 5,000PCS/roll

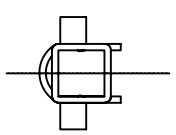

1	2	3	4	5	6	7	8	9	10	11	12	13	14
A	B	C	D	E	F	G	H	I	J	A	B	C	D
Rev		Description/Date		Drawn By: Storm.li		Customer:		Part No.:		Third angle projection		Units: mm	
△				Checked By: Simmon		WW420-FT1		General Dimension Tolerance		X.X ±0.10		X.XX ±0.02	
△				Approved By: Tony		Terminal		SOUTH SEA TERMINAL CO., LTD		X.XX ±0.01		X.XXX ±0.01	
1		SGS Report No.: KA/2005/40815/A-2		Title:									

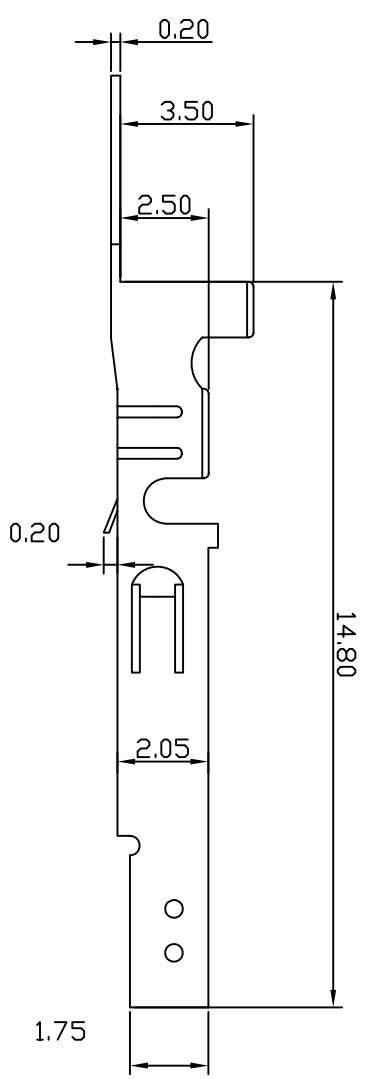
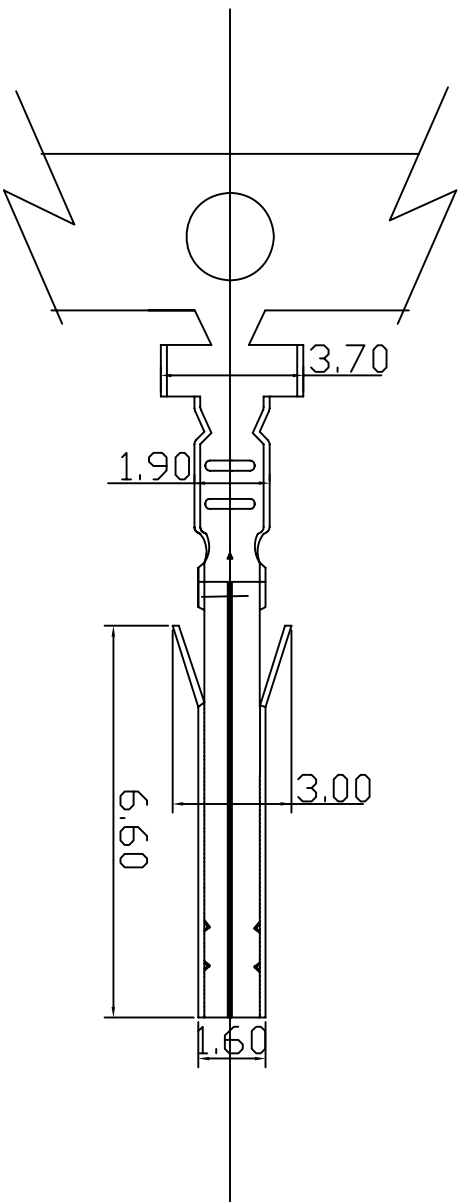

Material: Brass
 Thickness: 0.2mm
 Plating: Tin plated
 Wire Range: Suitable for AWG#18-22
 Insulation D.D: 3.0mm(max)
 QTY: 5,000PCS/roll

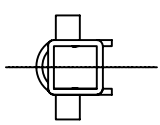
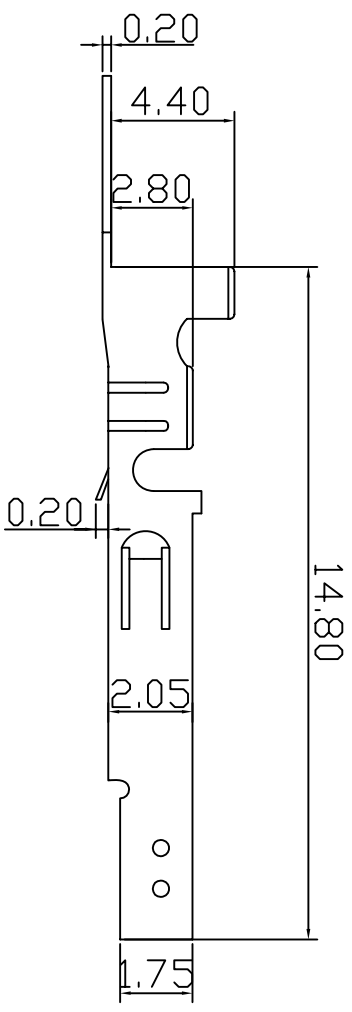

1	2	3	4	5	6	7	8	9	10	11	12	13	14						
J	I	H	G	F	E	D	C	B	A	J	I	H	G	F	E	D	C	B	A
Rev	Description/Date	Drawn By: Storm.li	Customer:	Part No.:	WV420-FT2	Third angle projection	Units: mm				X.X ±0.10	X.XX ±0.02	XXXX ±0.01						
△		Checked By: Simmon																	
△		Approved By: Tony		Title:	Terminal														
1	2	3	4	5	6	7	8	9	10	11	12	13	14						
SGS Report No.: KA/2005/40815/A-2					SOUTH SEA TERMINAL CO., LTD														

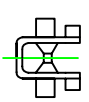
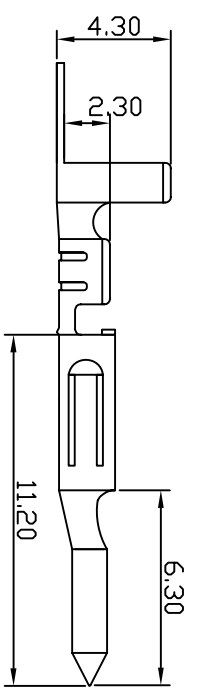
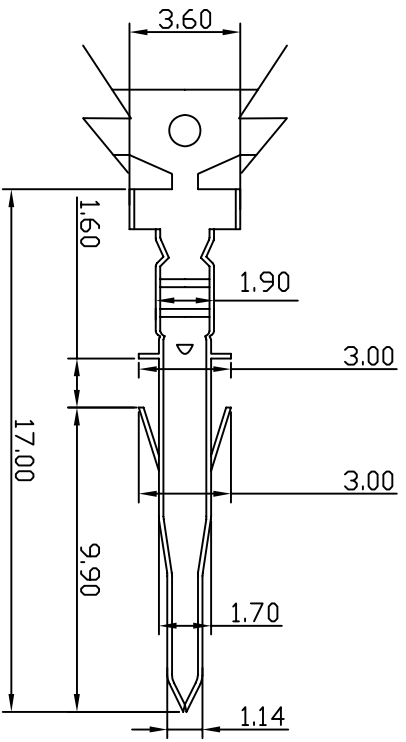

Part No: WW420-MT1
 Material: Brass
 Thickness: 0.2mm
 Plating: Tin plated 60u"
 Wire Range: Suitable for AWG#22-24
 Insulation: 0.125mm(max)
 QTY: 5,000PCS/roll

1	2	3	4	5	6	7	8	9	10	11	12	13	14						
J	I	H	G	F	E	D	C	B	A	J	I	H	G	F	E	D	C	B	A
Rev	Description/Date	Drawn By: Storm.li	Customer:	Part No.:	Terminal	Third angle projection	Units: mm								X.XX ±0.10	X.XX ±0.02	XXXX ±0.01		
△		Checked By: Simmon		WW420-MT1															
△		Approved By: Tony																	
SGS Report No.: KA/2005/40815/A-2																			

SOUTH SEA TERMINAL CO., LTD

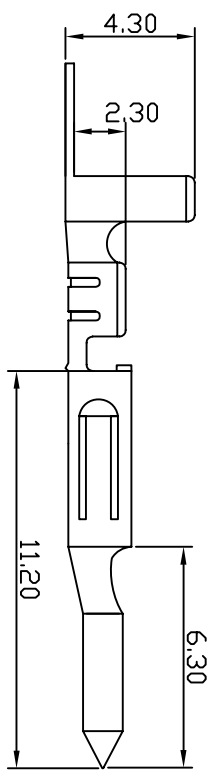
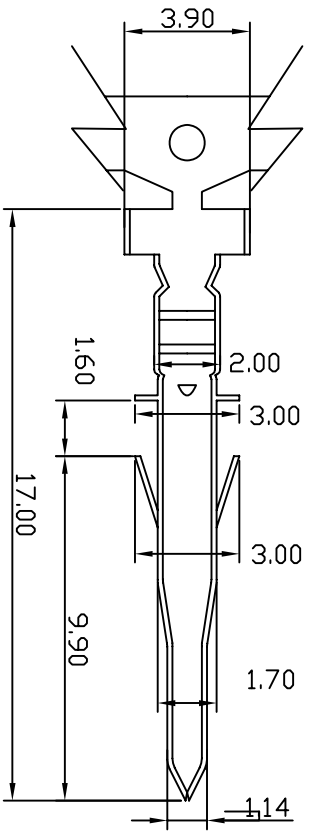

Part No:W420-MT2
 Material:Brass
 Thickness:0.2mm
 Plating:Tin plated 60u"
 Wire Range:Suitable for AWG#18-22
 Insulation D.D:3.0mm(max)
 QTY:5,000PCS/roll

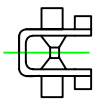

1	2	3	4	5	6	7	8	9	10	11	12	13	14	
1	2	3	4	5	6	7	8	9	10	11	12	13	14	
Rev	Description/Date	Drawn By: Storm.li	Customer:	Part No.:	W420-MT2	Third angle projection	Units: mm							
△		Checked By: Simmon												
△		Approved By: Tony		Title:	Terminal	General Dimension Tolerance	X.X ±0.10 X.XX ±0.02 XXXX ±0.01							
SGS Report No.: KA/2005/40815/A-2				SOUTH SEA TERMINAL CO., LTD										

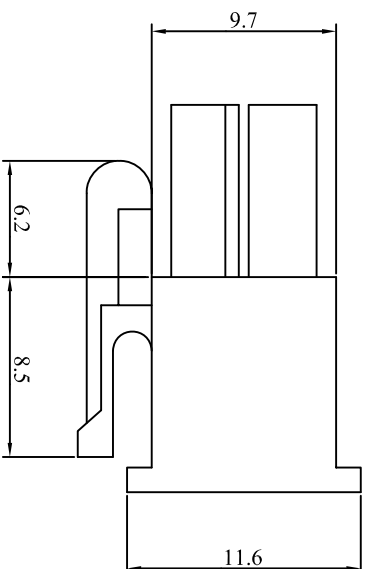
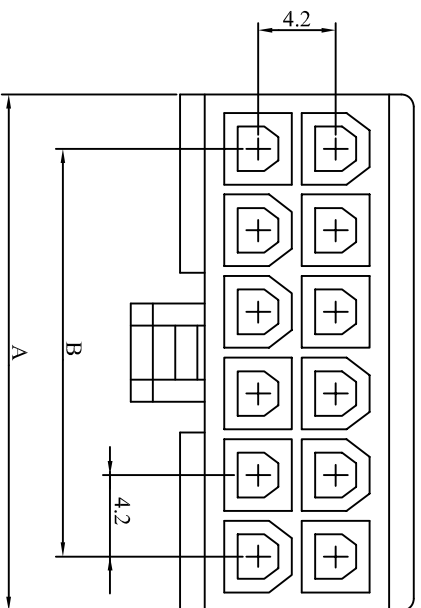

Material: Nylon66 UL 94V-2
 Accept WW420-FT Terminal
 Mate with WW420-F Series housing
 Mate with WW420-V(R)Series header
 Current rating:9A AC,DC
 Voltage rating: 600V AC,DC Min
 Contact resistance: 10m Ω Max
 Insulation resistance: 1,000M Ω Min
 Withstanding voltage: 1,500V AC/Minute
 Temperature range: -25° C to +85° C

Material Nylon66,UL94V-2

PATR NO	DIMENSION		
	A	B	
2	WW420-M02	5.5	
4	WW420-M04	9.7	4.2
6	WW420-M06	13.9	8.4
8	WW420-M08	18.1	12.6
10	WW420-M10	22.3	16.8
12	WW420-M12	26.5	21.0
14	WW420-M14	30.7	25.2
16	WW420-M16	34.9	29.4
18	WW420-M18	39.1	33.6
20	WW420-M20	43.3	37.8
22	WW420-M22	47.5	42.0
24	WW420-M24	51.7	46.2

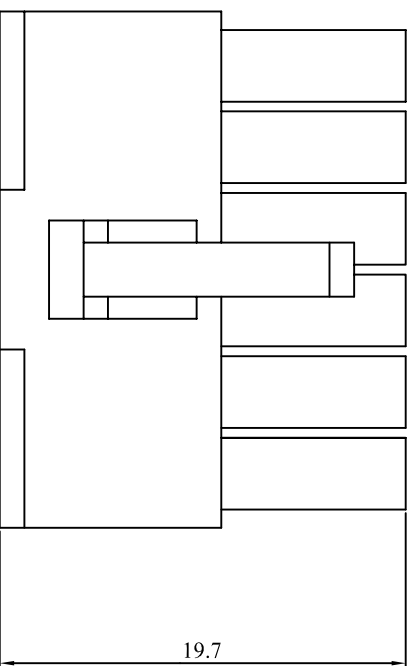

Rev	Description/Date	Drawn By: Storm.li
△		Checked By:Simmon
△		Approved By: Tony
SGS Report No.: KA/2004/80788/A-2		

Customer:	Part No.:	Title:
	WW420-MXX	Mini-Fit Male housing

Third angle projection	Units: mm
General Dimension Tolerance	X.X ±0.10 X.XX ±0.02 XXXX ±0.01
SOUTH SEA TERMINAL CO.,LTD	

1 2 3 4 5 6 7 8 9 10 11 12 13 14

Current: (use with 16 AWG)

Circuits	2-3	4-6	7-10	12-24
A	9	8	7	6

Mate with: WW420-M Series housing
 Current rating: 9A AC, DC Max
 Voltage rating: 600V AC/DC
 Contact resistance: 10mΩ Max
 Insulation resistance: 1000MΩ Min
 Withstanding voltage: 1500V AC/Minute
 Temperature range: -25°TO+85°

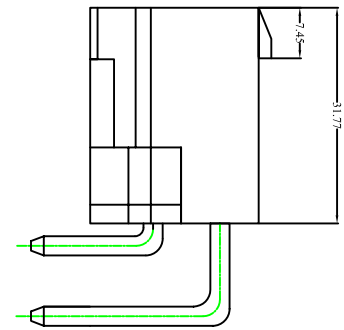
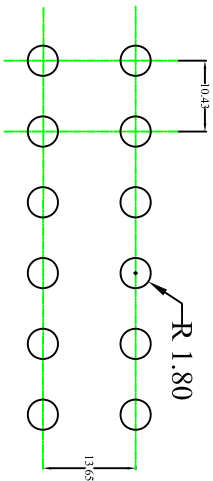

Poles	Part No	Dimensions(mm)	
		A	B
2	WW420-R02	5.40	
4	WW420-R04	9.60	4.20
6	WW420-R06	13.80	8.40
8	WW420-R08	18.00	12.60
10	WW420-R10	22.20	19.80
12	WW420-R12	26.40	21.00
14	WW420-R14	30.60	25.20
16	WW420-R16	34.80	29.40
18	WW420-R18	39.00	33.60
20	WW420-R20	43.20	37.80
22	WW420-R22	47.40	42.00
24	WW420-R24	51.60	46.20

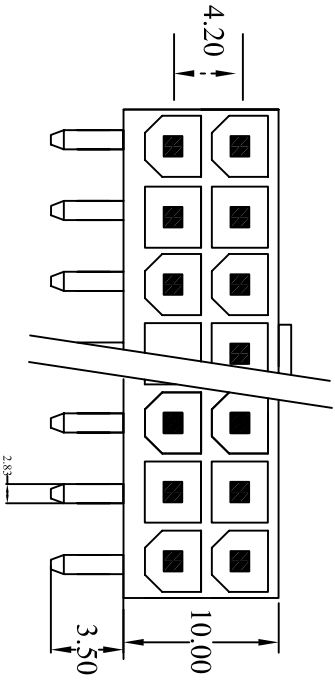

Rev Description/Date Drawn By: Storm.li Customer: Third angle projection  Units: mm

Checked By: Simmon Part No.: WW420-RXX General Dimension Tolerance XX ±0.10 XXX ±0.02 XXXX ±0.01

Approved By: Tony Title: Mini-Fit Wafer SOUTH SEA TERMINAL CO., LTD

SGS Report No.: KA/2005/40815/A-2

Mate with: WW420-M Series housing
 Current rating: 9A AC,DC Max
 Voltage Rating: 600V AC/DC
 Contact resistance: 10mΩMax
 Insulation resistance: 1000MΩMin
 Withstanding voltage : 1500V AC/Minute
 Temperature range: -25TO+85°

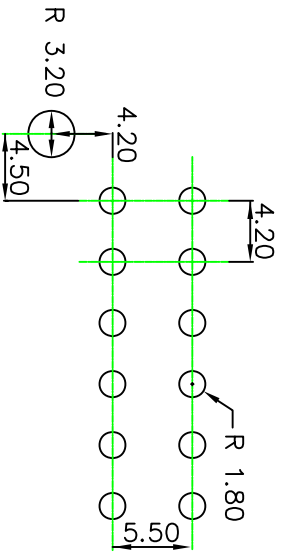
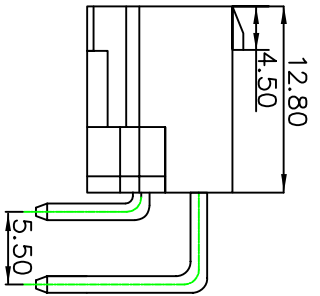
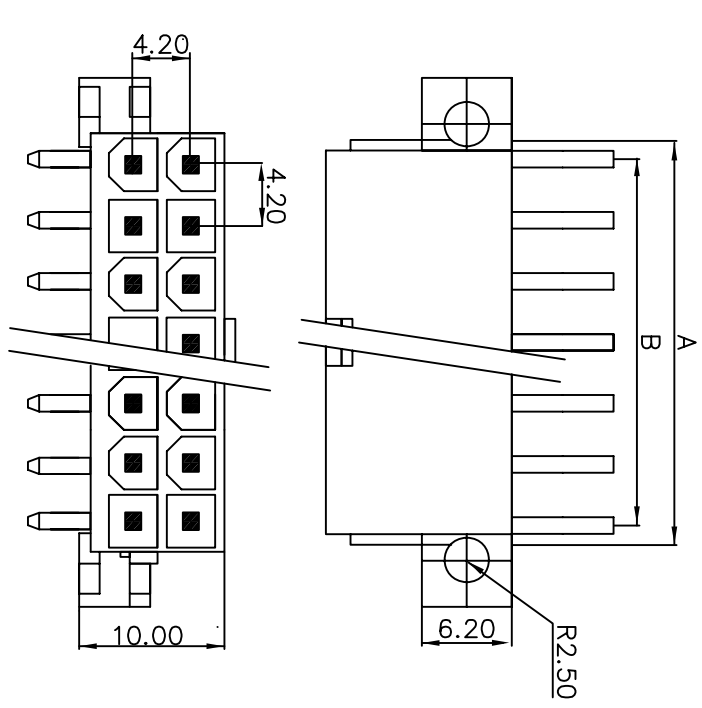

Poles	Part No	Dimensions(mm)	
		A	B
2	W/W420-R02F	5.40	
4	W/W420-R04F	9.60	4.20
6	W/W420-R06F	13.80	8.40
8	W/W420-R08F	18.00	12.60
10	W/W420-R10F	22.20	19.80
12	W/W420-R12F	26.40	21.00
14	W/W420-R14F	30.60	25.20
16	W/W420-R16F	34.80	29.40
18	W/W420-R18F	39.00	33.60
20	W/W420-R20F	43.20	37.80
22	W/W420-R22F	47.40	42.00
24	W/W420-R24F	51.60	46.20

Current: (use with 16 AWG)

Circuits	2-3	4-6	7-10	12-24
A	9	8	7	6

P.C. Board layout

Rev	Description/Date	Drawn By: Storm.li	Customer:	Third angle projection	Units: mm								
△		Checked By: Simmon	WW420-RXXF		XX XXX ±0.25 ±0.1 ±0.08								
△		Approved By: Tony											
SGS Report No.: KA/2004/80788/A-2		Title: Mini-Fit Male Wafer		SOUTH SEA TERMINAL CO.,LTD									
1	2	3	4			5	6	7	8	9	10	11	12

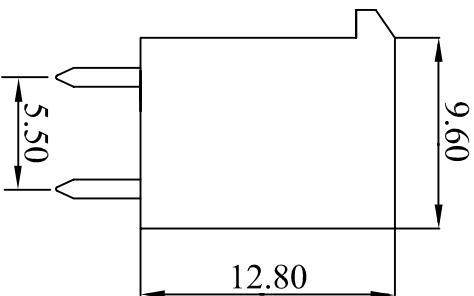
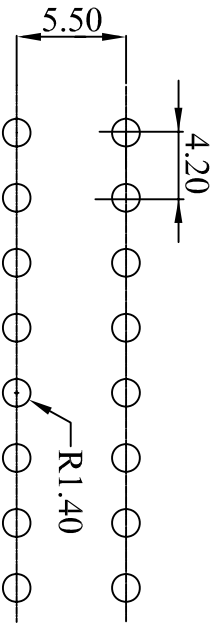
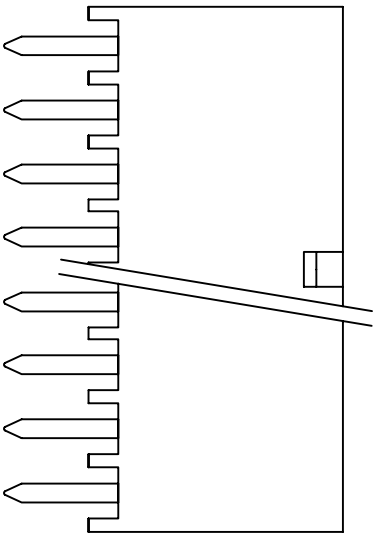
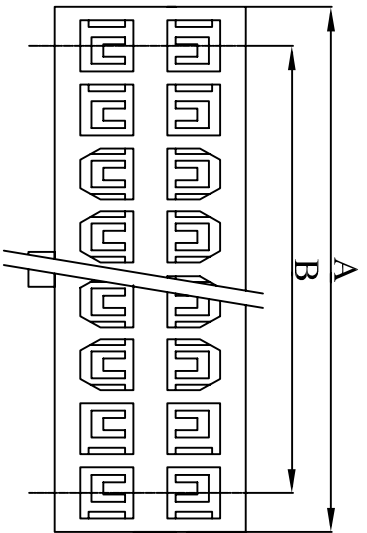

Current: (use with 16 AWG)

Circuits	2-3	4-6	7-10	12-24
A	9	8	7	6

Mate with: WW420-M Series housing
 Current rating: 9A AC, DC Max
 Voltage Rating: 600V AC/DC
 Contact resistance: 10mΩMax
 Insulation resistance: 1000MΩMin
 Withstanding voltage: 1500V AC/Minute
 Temperature range: -25° TO +85°

Poles	Part No	Dimensions(mm)	
		A	B
2	WW420-V02	5.40	
4	WW420-V04	9.60	4.20
6	WW420-V06	13.80	8.40
8	WW420-V08	18.00	12.60
10	WW420-V10	22.20	19.80
12	WW420-V12	26.40	21.00
14	WW420-V14	30.60	25.20
16	WW420-V16	34.80	29.40
18	WW420-V18	39.00	33.60
20	WW420-V20	43.20	37.80
22	WW420-V22	47.40	42.00
24	WW420-V24	51.60	46.20

Rev Description/Date Drawn By: Storm.li Customer: Third angle projection Units: mm

Checked By: Simmon Part No.: WW420-VXX General Dimension Tolerance XX ±0.25 XXX ±0.1 XXXX ±0.08

Approved By: Tony Title: Mini-Fit Male Wafer SOUTH SEA TERMINAL CO., LTD

SGS Report No.: KA/2004/80788/A-2

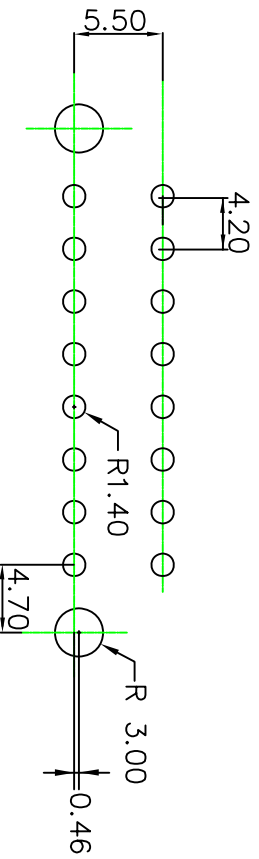
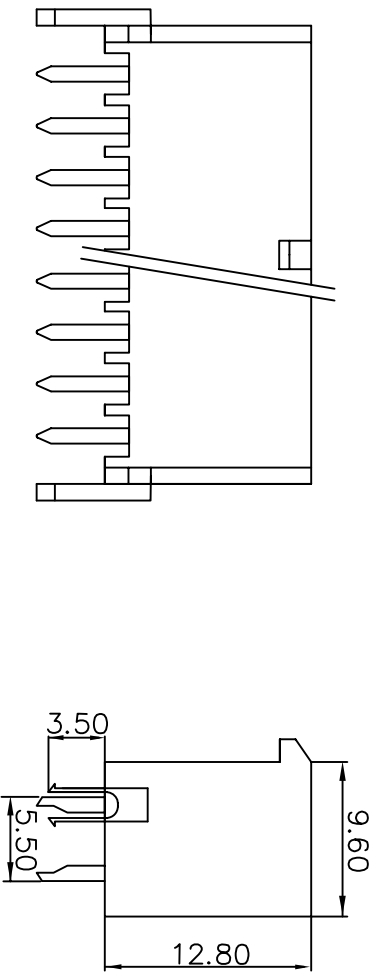
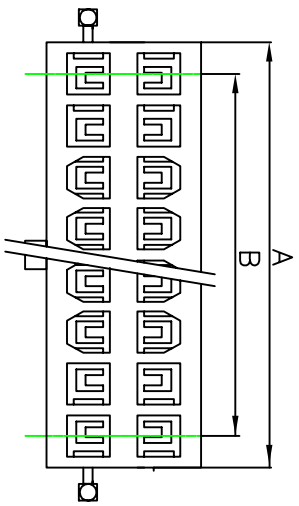

Mate with: WW420-M Series housing
 Current rating: 9A AC,DC Max
 Voltage Rating: 600V ACDC
 Contact resistance: 10mΩMax
 Insulation resistance: 1000MΩMin
 Withstanding voltage : 1500V AC/Minute
 Temperature range: -25*10+85°

Poles	Part No	Dimensions(mm)	
		A	B
2	W/W420-V02P	5.40	
4	W/W420-V04P	9.60	4.20
6	W/W420-V06P	13.80	8.40
8	W/W420-V08P	18.00	12.60
10	W/W420-V10P	22.20	19.80
12	W/W420-V12P	26.40	21.00
14	W/W420-V14P	30.60	25.20
16	W/W420-V16P	34.80	29.40
18	W/W420-V18P	39.00	33.60
20	W/W420-V20P	43.20	37.80
22	W/W420-V22P	47.40	42.00
24	W/W420-V24P	51.60	46.20

Current: (use with 16 AWG)

Circuits	2-3	4-6	7-10	12-24
A	9	8	7	6

P.C.Board layout

Rev Description/Date

Drawn By: Storm.li

Customer:

Part No.: WW420-VXXP

Third angle projection



Units: mm

Checked By: Simmon

Approved By: Tony

Part No.:

Mini-Fit Male Wafer

General Dimension Tolerance

XX ±0.25 XXX ±0.1 XXXX ±0.08

SGS Report No.: KA/2004/80788/A-2

Title:

Mini-Fit Male Wafer

SOUTH SEA TERMINAL CO.,LTD