

WW200-MT

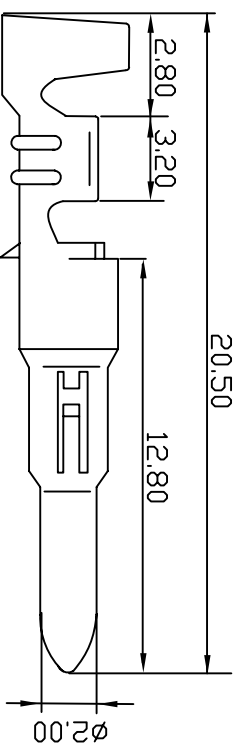

WW200-FT

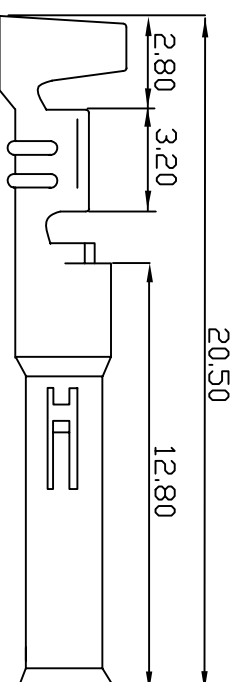

Part No.	Wire range		Material/ Finish	Thickness mm	Insulation D.D.(mm)	Reel Pcs
	Awg#	mm ²				
WW200-MKF)T1	20-24	0.5-0.2	Brass/Tin	0.25	2.7-1.5	5,000
WW200-MKF)T2	14-20	2.0-0.5	Brass/Tin	0.25	3.9-1.9	3,500

Rev Description/Date Drawn By: Storm.li

Checked By: Simmon
Approved By: Tony

Customer:

Part No.:

Third angle projection

General Dimension Tolerance

Units:
mm

X.X ±0.25
X.XX ±0.1
X.XXX ±0.08

SGS Report No.: KA/2005/40815/A-2

Title:

Terminal

SOUTH SEA TERMINAL CO., LTD

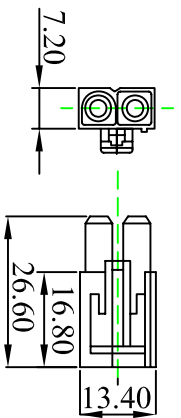

WW200-M02(15A/300V)

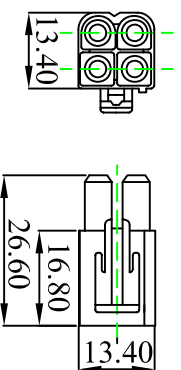

WW200-M04(13A/300V)

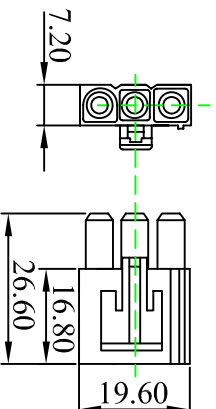

WW200-M03(14A/300V)

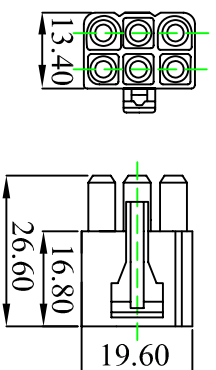

WW200-M06(12A/300V)

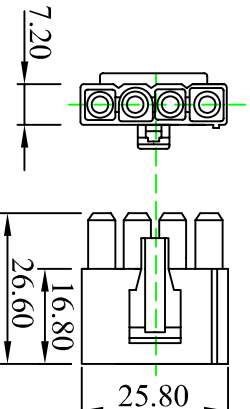

WW200-M04(13A/300V)

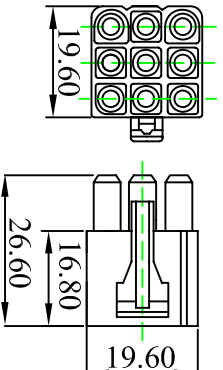

WW200-M09(10A/300V)

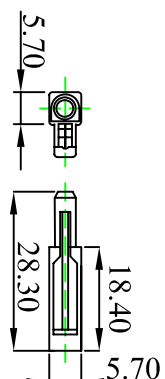

WW200-M01(15A/600V)

Material: Nylon 66 UL94V-2
 Mate with: WW200-F Series housing
 Current rating: 15A AC, DC Max
 Voltage Rating: 600V AC, DC Max
 Contact resistance: 15mΩ Max
 Insulation resistance: 1000MΩ Min
 Withstanding voltage: 1500V AC/Minute
 Temperature range: -25°C to +85°C
 Applicable panel thickness: 0.8 to 2.0 mm

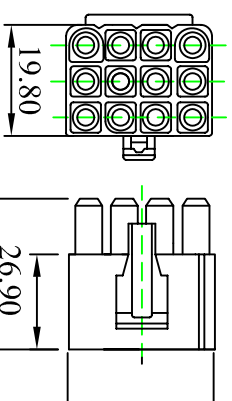

WW200-M12(9A/300V)

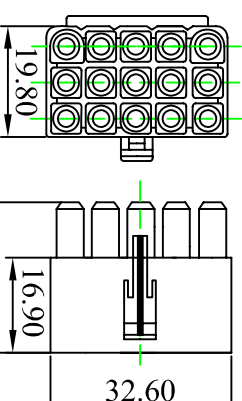

WW200-M12(9A/300V)

Rev	Description/Date	Drawn By: Storm.li	Customer:	Third angle projection	Units: mm
△		Checked By: Simmon	Part No.:	General Dimension Tolerance	X.X ±0.25 X.XX ±0.1 XXXX ±0.08
△		Approved By: Tony	Title:	Housing	
SGS Report No.: KA/2004/80788/A-2					

SOUTH SEA TERMINAL CO., LTD

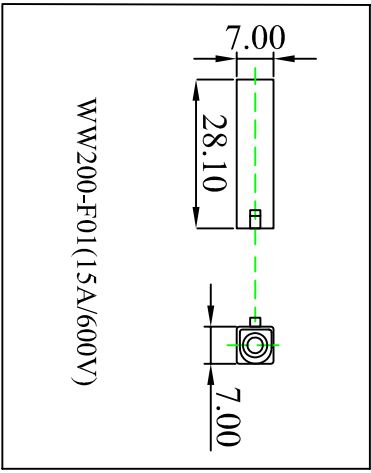

Material: Nylon 66 UL94V-2
 Mate with: WW200-M Series housing
 Current rating: 15A AC, DC Max
 Voltage Rating: 600V AC, DC Max
 Contact resistance: 15mΩ Max
 Insulation resistance: 1000MΩ Min
 Withstanding voltage: 1500V AC/Minute
 Temperature range: -25° C TO +85° C
 Applicable panel thickness: 0.8 to 2.0 mm

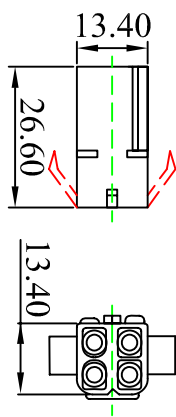
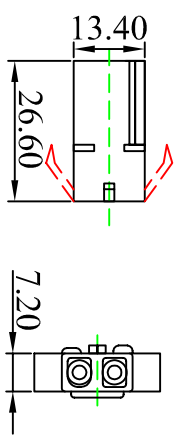

WW200-F02(15A/300V)

WW200-F04-1(13A/300V)

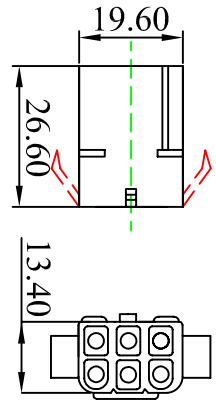
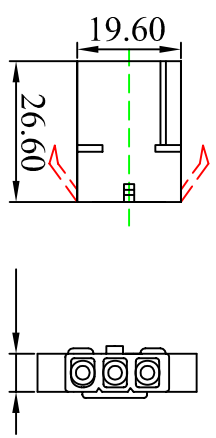

WW200-F03(14A/300V)

WW200-F06(12A/300V)

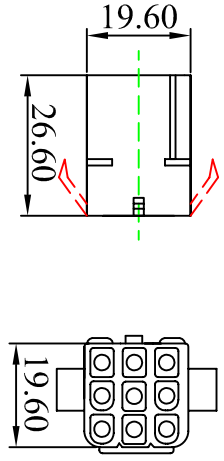
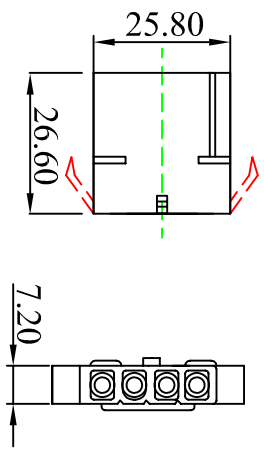

WW200-F04(13A/300V)

WW200-F09(10A/300V)

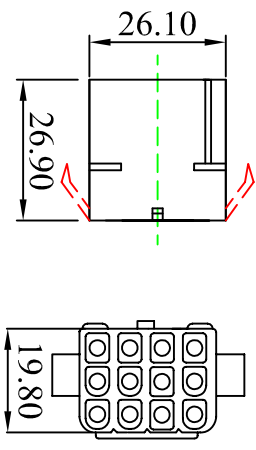

WW200-F12(9A/300V)

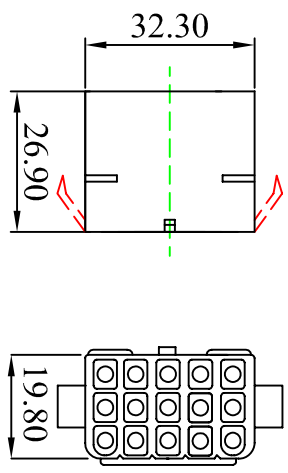

WW200-F15(9A/300V)

Rev	Description/Date	Drawn By: Storm.li	Customer:	Third angle projection	Units: mm
△		Checked By: Simmon	WW200-F Series	General Dimension Tolerance	X.X ±0.25 X.XX ±0.1 XXXX ±0.08
△		Approved By: Tony	Title:	SOUTH SEA TERMINAL CO., LTD	
SGS Report No.: KA/2004/80788/A-2					

Location of Circuits

WW200-M

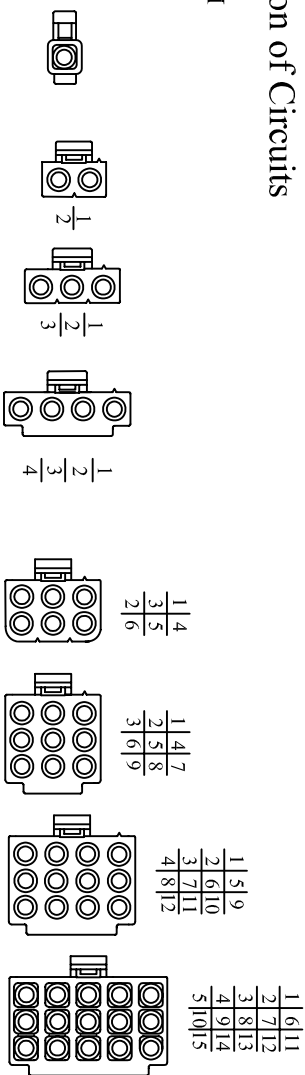

WW200-F

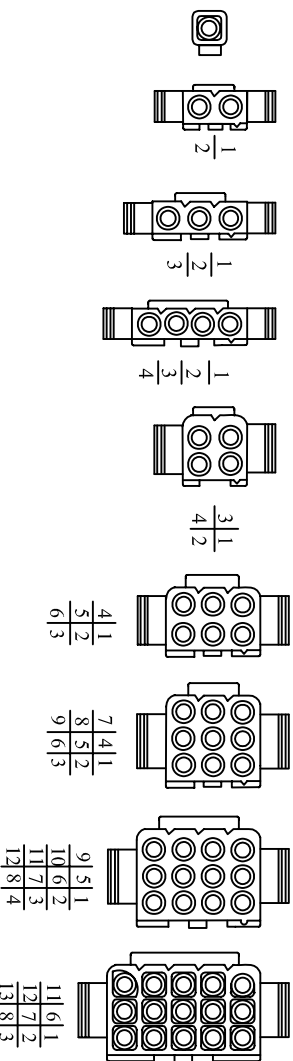

Circuit	Type	Dimension/mm			
		A	B	C	D
1	I	—	—	—	—
2	I	—	18.8	7.8	11.0
3	I	—	25.0	7.8	11.0
4(1*4)	I	—	31.2	7.8	11.0
4(2*2)	II	13.8	18.8	9.4	14.1
6	II	20.0	18.8	9.4	14.1
9	II	20.0	18.8	9.4	20.3
12	II	26.2	18.8	12.8	20.3
15	II	32.4	18.8	12.8	20.3

Terminal remover

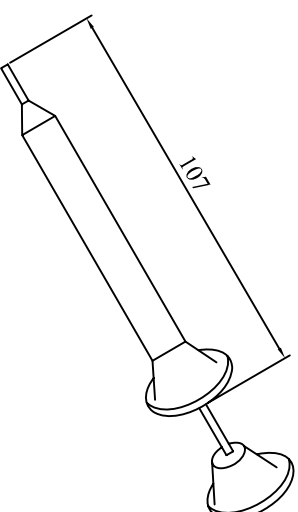

Type: I

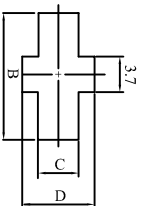

Type: II

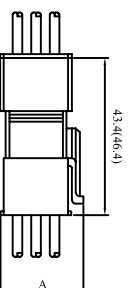
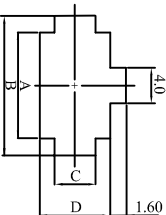

Rev Description/Date

Drawn By: Storm.li

Customer:

WW200-M&F

Third angle projection



Units: mm

Checked By: Simmon

Part No.:

Location of Circuits

General Dimension Tolerance

X.X ±0.25 X.XX ±0.1 XXXX ±0.08

Approved By: Tony

Title:

Location of Circuits

SGS Report No.: KA/2004/80788/A-2

Location of Circuits

SOUTH SEA TERMINAL CO., LTD