

Rev	Revisions	Rev.Drawn	Date
A		Du	13.DEC.2011

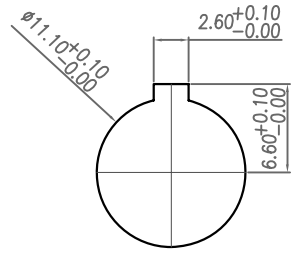

RECOMMENDED MOUNTING HOLE

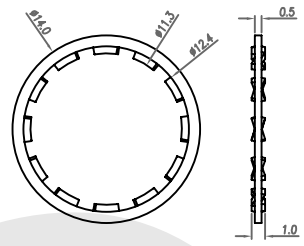
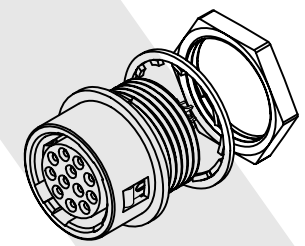
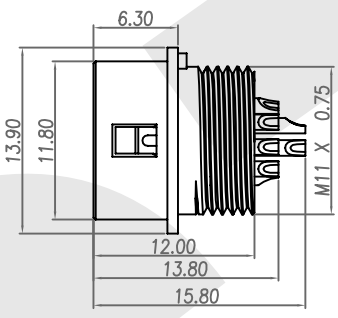
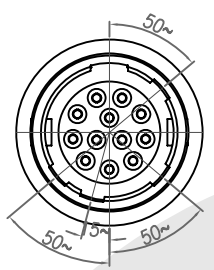

WASHER

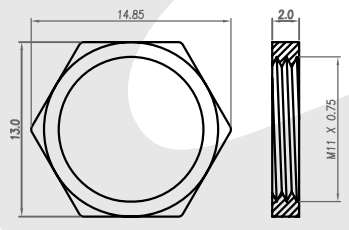

NUT

1. MATERIAL :
- 1-1. HOUSING : NYLON46 UL94V-0; COLOR : BLACK
 - 1-2. CONTACT : BRASS
 - 1-3. SHELL : ZINC ALLOY
 - 1-4. SPRING : STAINLESS STEEL
 - 1-5. WASHER : PHOSPHOR BRONZE
 - 1-6. NUT : BRASS
2. FINISH :
- 2-1. CONTACT : GOLD FLASH
 - 2-2. SHELL : NICKEL
 - 2-3. WASHER : NICKEL
 - 2-4. NUT : NICKEL

3. ORDERING INFORMATION : P-P(PUSH PULL) CONNECTOR

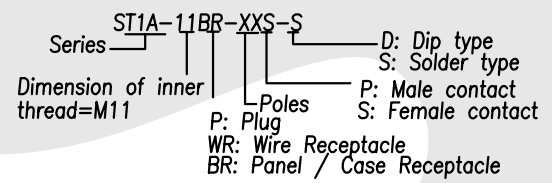

TABLE A

CONTACT ARRANGEMENT & DIMENSIONS(FRONT VIEW)	
<p>ST1A-11BR-12S-S</p>	<p>ST1A-11BR-10S-S</p>

SST SOUTH SEA TERMINAL CO.,LTD

SGS Report No.: Customer: Part No.: ST1A-11BR-XXS-S

Title: P-P CONN. Panel/Case Receptacle Solder Type (F)

Drawn By: Storm.Li	SCALE: 1:1	SHEET: 1/1	REV.: A	DWG NO.: QC5555	TOLERANCE: .x ±0.20
Checked By: du	Third angle Projection			Units: mm	.xx ±0.10
Approved By: Tony	General Dimension Tolerance				.xxx ±0.05
					.xxxx ±0.03
					ANGULA ±1°