

Rev	Revisions	Rev.Drawn	Date
A		Du	26/01/11"

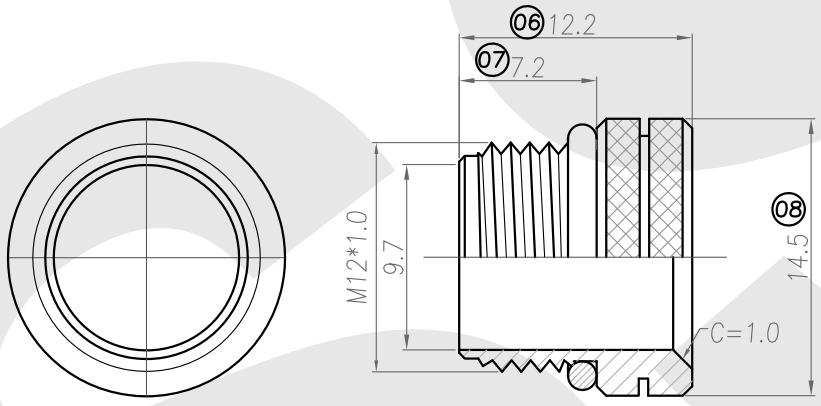
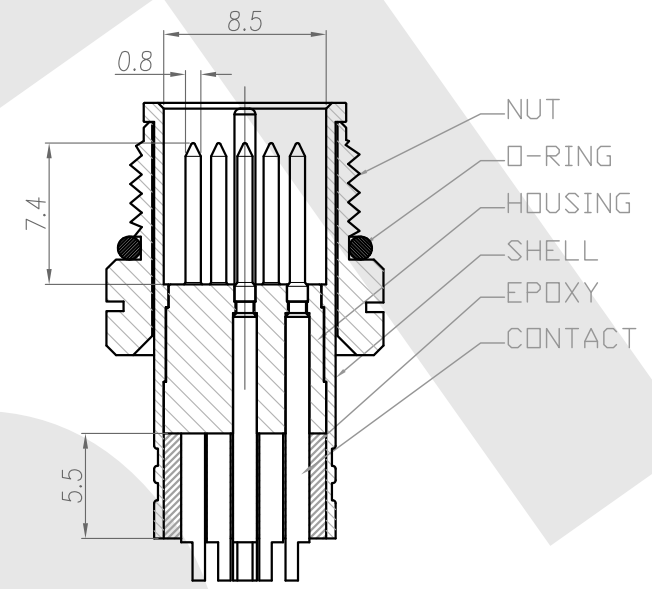
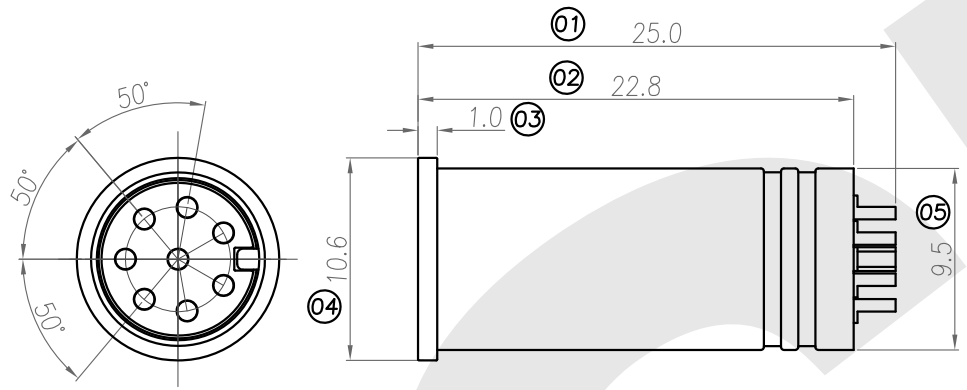

NUT

1. MATERIAL :
 - 1-1. HOUSING : PBT UL94V-0 ; COLOR : BLACK
 - 1-2. CONTACT : BRASS
 - 1-3. NUT : BRASS
 - 1-4. O-RING : EDPM
 - 1-5. SHELL : ZINC ALLOY
 - 1-6. EPOXY Base :EF400A&EF400B.COLOR:BLACK
2. FINISH :
 - 2-1. CONTACT : 10 MICRO INCHES MIN. GOLD PLATED
UNDER PLATE : NICKEL
 - 2-2. NUT : NICKEL PLATED
 - 2-3. SHELL : MATTE TIN
3. ELECTRICAL SPECIFICATION :
 - 3-1. Rated current : 5A
 - 3-2. Rated Voltage : 125V
 - 3-3. Water proof: IPX7
4. Environmental :
 - 4-1. Operation Temperature : -40C~85C

SST SOUTH SEA TERMINAL CO.,LTD

SGS Report No.: Customer: Part No.:
12MBP-W-A-12.2-M-1-G10-B-N-3

Title:M12 MALE SOLDER TYPE for CABLE (GROUND)

Drawn By:Storm.Li	SCALE	SHEET	REV.	DWG NO.:	TOLERANCE: .x ±0.20 .xx ±0.10 .xxx ±0.05 .xxxx ±0.03 ANGULA ±1*
Checked By:du	1:1	1/1	A	/	
Approved By:Tony	Thire angle Projection		General Dimension Tolerance		

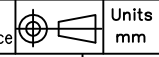

Units
mm